



www.arnscott.com

Loudspeaker Baffles



G15 Series

G15 Series
Round Acoustic Baffles for 4-5"
Loudspeakers



G15W

FEATURES

- Powder coat finish is hard wearing and durable
- Two screw mount for a quicker installation
- Simple to install or retrofit
- Welded Speaker studs
- Two Piece construction for model G15PW



G15PW



www.arnscott.com

G15 Series

Round Acoustic Baffles for 4-5" Loudspeakers

G15 Series

SPECIFICATIONS

Back-boxes that work with these baffles:

Standard Screw Mount:
E15, E15-4, E15-6L

Note: All models are equipped with welded speaker mounting studs unless otherwise noted. Mounting screws and speaker nuts are included.
All baffles can be custom painted to match a particular colour scheme. Send us a colour match and we would be pleased to quote you.

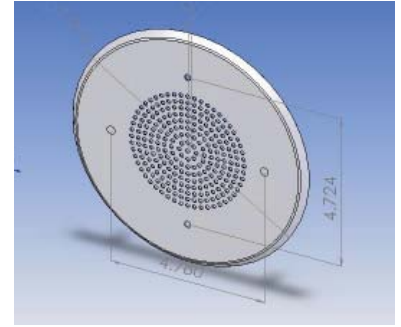

Model No.	Diameter	Mount	Flange Ht.	Spkr Mnt	Material	Finish	ULC Listed
Screw Mount:							
G15W	7-3/8"	4-3/4	3/16"	weld studs	20 Ga CRS	White Powder	Yes
G15PW	7-3/8"	4-3/4"	3/16"	weld studs	20 Ga CRS-2 Pc.	White Powder	No

ARCHITECTS AND ENGINEERS SPECIFICATIONS

MODEL G15W

The flush ceiling baffle shall be AEG Model G15W. The baffle shall be fabricated from one piece of steel, finished in semi-gloss white powder paint and shall measure 18.7cm (7-3/8") round and 0.5cm (3/16") deep. The 4 - 5 inch loudspeaker shall mount on two concealed studs, very labour efficient. Two holes shall be provided to mount the baffle on AEG Models E15, E15-4, E15-6L, or E50 + E50ER extension enclosure.

MODEL G15PW

The flush ceiling baffle shall be AEG Model G15PW. The baffle shall be fabricated from two pieces of steel, finished in white powder paint and shall measure 18.7cm (7-3/8") round and 0.5cm (3/16") deep. The 4 - 5 inch loudspeaker shall mount on two concealed studs, very labour efficient. Two holes shall be provided to mount the baffle on AEI Models E15, E15-4, E15-6L, or E50 plus E50ER enclosures.