



www.arnscott.com

Loudspeaker Baffles



G11 Series

G11 Series

Round Acoustic Baffles for 8"
Loudspeakers



G11W



GA11W

FEATURES

- Powder coat finish is hard wearing and durable
- One piece construction
- Simple to install or retrofit
- Torsion spring mounts on the GA11W model, no visible screws!
- Economical design
- Some Models approved for ULC™ Listed Fire Alarm Installations



www.arnscott.com

G11 Series

Round Acoustic Baffles for 8" Loudspeakers

G11 Series

SPECIFICATIONS

Back-boxes that work with these baffles:

Standard Screw Mount:

E10, E10-5, E10-7, E10-10, E10-7L, E10-10L, E24, SE24

Torsion Mount:

EA10

Note: All models are equipped with welded speaker mounting studs unless otherwise noted.

All baffles can be custom painted to match a particular colour scheme. Send us a colour match and we would be pleased to quote you.

In order to fulfill ULC listing requirements, this baffle must be installed on an Arnscott Fire Rated Speaker Assembly, and used with it's appropriate AEG back-box.

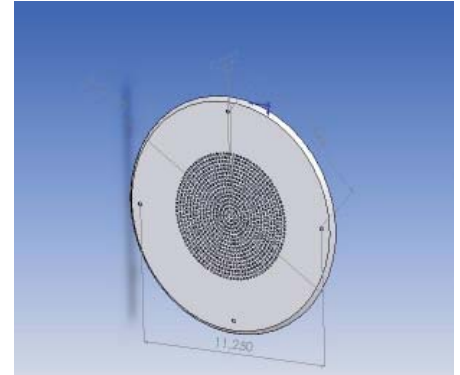

| Model No. | Diameter | Mount | Flange Ht. | Spkr Mnt | Material | Finish | ULC Listed |
|----------------|----------|---------|------------|------------|------------------|--------------|------------|
| Screw Mount: | | | | | | | |
| G11W | 12-3/4" | 11-1/4" | 3/16" | weld studs | 20 GA CRS | White Powder | Yes |
| G11W-14 | 12-3/4" | 9-3/16" | 3/16" | weld studs | 20 GA CRS | White Powder | Yes |
| G11A | 12-3/4" | 11-1/4" | 3/16" | Hardware | 22 Ga. Aluminum | Natural | No |
| G11SS | 12-3/4" | 11-1/4" | 3/16" | weld studs | 22 Ga. Stainless | Brushed | No |
| G11W-NP | 12-3/5" | 11-1/4" | 3/16" | No Perf | 20 Ga CRS | White Powder | No |
| Torsion Mount: | | | | | | | |
| GA11W | 12-3/4" | N/A | 3/16" | weld studs | 20 GA CRS | White Powder | No |

Note: G11W-14 is designed to mount to AEG E14 back-box for flush concrete applications.

ARCHITECTS AND ENGINEERS SPECIFICATIONS

MODEL G11W / G11SS / G11W-14

The flush ceiling baffle shall be an ARNSCOTT Model G11W / G11SS / G11W-14. The baffle shall be fabricated from one piece of steel (G11SS fabricated from 0.035" brushed stainless steel), finished in semi-gloss white powder paint (G11SS is not painted, natural brushed finish) and shall measure 32.4cm (12-3/4") round and 0.5cm (3/16") deep. The 8-inch loudspeaker shall mount on concealed studs. Four holes shall be provided to mount the baffle to ARNSCOTT Model E10, E10-5, E10-7L, E10-10L, E10S or E24, SE24 recessed enclosures. The G11W-14 mounts to AEG model E11 back-box. G11W-NP is the same as G11W, without perf of studs. This unit is designed to be a cover.

MODEL GA11W

The flush ceiling baffle shall be an ARNSCOTT Model GA11W. The baffle shall be fabricated from one piece of steel, finished in semi-gloss white powder paint and shall measure 32.4cm (12-3/4") round and 0.5cm (3/16") deep. The 8-inch loudspeaker shall mount on concealed studs. Concealed torsion springs shall be provided to mount the baffle to ARNSCOTT Model EA10, or special ordered EA10-10 recessed enclosures.

MODEL G11A

The flush ceiling baffle shall be an ARNSCOTT Model G11A. The baffle shall be fabricated from one piece of 0.030" aluminum, with a natural finish. G11AW is available as a special order with a semi-gloss white powder paint finish. The baffle shall measure 32.4cm (12-3/4") round and 0.5cm (3/16") deep. The 8-inch loudspeaker shall mount with four screws and nuts, the screw heads are visible from the front of the baffle. Four holes shall be provided to mount the baffle to ARNSCOTT Model E10, E10-5, E10-7, E10-10, E10S or E24 recessed enclosures.

ULC is a Trademark of Underwriters Laboratories of Canada

Specifications subject to change without notice

www.arnscott.com

sales@arnscott.com