

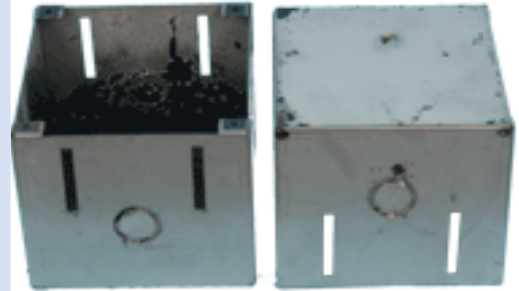

www.arnscott.com

Acoustic Back-Boxes



E40

# E40 Series

## E40 Series

Square Acoustic Back-Box for 4-5" Loudspeakers



SE40SB-5L



SE40SB

### FEATURES

- Rust resistant heavy gauge electro-plated steel
- Mounting slots punched into the sides of the flush mount boxes for easy mounting to the MC1-P Mounting Channels
- Some Models acoustically treated interior helps reduce mechanical resonance
- Custom depths and k/o configurations are available
- Some Models are approved for ULC™ Listed Installations
- Surface and flush mounting options available



www.arnscott.com

# E40 Series

## Square Acoustic Back-Box for 4-5" Loudspeakers

E40 Series

### SPECIFICATIONS

#### Baffles that work with these back-boxes:

Standard Screw Mount:  
G70W, G70PW  
Torsion Mount:  
N/A

Note: k/o's are 2" centered from the back on 2 sides at 180 degrees from each other.

Back-box can be custom configured, send us a drawing or sketch and we would be pleased to quote you.

In order to fulfill ULC listing requirements, this back box must be installed with an Arnscott Fire Rated Speaker.

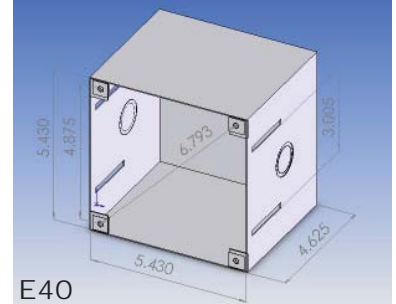

E40

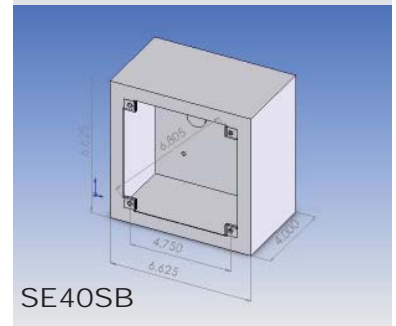

SE40SB

Model No.	Depth	Lined	Spray Dampened	Cubic Feet	Mounting	ULC Listed
Screw Mount:						
E40	4-5/8"	No	Yes	0.08	MC1-P	Yes
SE40SB	4"	No	No	0.10	N/A	Yes
SE40SB-5L	5"	Yes	No	0.13	N/A	No

### ARCHITECTS AND ENGINEERS SPECIFICATIONS

#### MODEL E40 (Flush Mount)

The ceiling BACKBOX shall be AEG Model E40. The back-box shall be constructed of electro-plated steel. Two combination 1/2" - 3/4" knockouts for conduit are installed on the sides. The unit shall measure 14 cm (5-1/2") square at the base & front, and have a maximum depth of 10cm (4-5/8")(See chart above for complete information). This back Box is acoustically lined with a water based material to help reduce mechanical resonance. These units shall be used wherever recessed ceiling or wall mount conditions exist. This back box can be used for poured concrete applications. The E40 is ULC listed and is equipped with a ground screw. These backboxes shall accommodate AEG baffle Models G70W & G70PW.

#### MODELS SE40SB, SE40SB-5L (Surface Mount)

The ceiling BACKBOX shall be AEG Models SE40SB or SE40SB-5L. The back-box shall be constructed of cold rolled steel, and painted white. Two combination 1/2" - 3/4" knockouts for conduit are installed on the sides, one in the back middle for the SE40SB, and two on the back for the SE40SB-5L. The unit shall measure 16.8 cm (6-5/8") square at the base & front, and have a maximum depth of 12.7cm (5")(See chart above for complete information). The SE40SB is not lined, the SE40SB-5L is lined with 5/16" thick fire retardant acoustical insulation, with a density of 3 Lb. per Ft<sup>3</sup>. These units shall be used wherever surface mounted ceiling or wall mount conditions exist. This back box can be used for poured concrete applications, surface mount with conduit. The SE40SB is ULC listed and is equipped with a ground screw. These backboxes shall accommodate AEG baffle Models G70W & G70PW.

ULC is a Trademark of Underwriters Laboratories of Canada